

**Nederman**

IMPROVING YOUR WORKSPACE



**BenchTop Extraction Arms  
with unbeatable flexibility**

# A new generation of BenchTop extraction arms with unbeatable flexibility

Nederman introduces a new generation of BenchTop arms - the FX50, FX75 and FX100. These arms represent state-of-the-art technology based on Nederman's extensive experience of creating solutions to provide safe and clean working environments.

The arms are made of anodized aluminium tubing with polypropylene joints, offering strength and durability combined with light and easy handling. They are especially suitable for applications where small, flexible and easy-to-use arms are required to eliminate smoke, gases, dust and particles. For example, when soldering and gluing or handling solvents and noxious substances. Nederman BenchTop arms are designed to provide many years of trouble-free operation.

## Industrial, research and educational applications

BenchTop arms offer perfect solutions for numerous types of workplaces. These can be found, for example, in:

- *Chemical and pharmaceutical plants*
- *Electronics assembly factories*
- *Research laboratories*
- *School chemistry laboratories and technical workshops*

For quick installation there is a range of self-assembly kits, complete with fans and filters. For more advanced applications we can provide customized solutions to meet specific requirements.

## Ceiling, wall, floor or bench mounting

The multi-purpose mounting bracket allows complete freedom when planning installation points for the arms. They can be mounted on ceilings, walls and floors or fixed to worktops.





**Unique manoeuvrability**

The two outermost joints in the arm can rotate and swivel through 360°. This provides unequalled omni-directional flexibility and makes it possible to position the hood exactly where required. Once correctly positioned, the hood can be locked in place using two friction devices in the arm joints.

**Designed for optimal efficiency and low noise**

Computerized simulations were used in the development of this new series of extractors to create arms with optimal airflow and particle transportation properties. The resulting highly improved airflows mean that smaller and less energy-consuming fans are required.

Another user benefit is the reduced noise level. Depending on the airflow, this means a reduction of about 5dB, or more, when compared with similar arms on the market.



**Mounting alternatives**

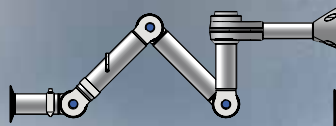

*Wall mounting  
Connection up*

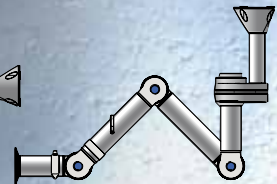

*Ceiling mounting  
Connection up*

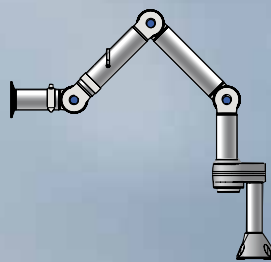

*Floor mounting  
Connection down*

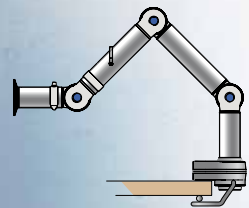

*Bench mounting  
Connection down*

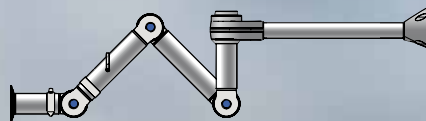

*The arm's operational reach can be increased by using an extension profile. This means that one arm can be used by a number of adjacent work stations.*

# Arms for every application

The Nederman BenchTop arms can be used in every type of environment, ranging from assembly stations, where solder fumes are extracted, to laboratories, where protection against highly

corrosive or noxious gases is vital.

Three different BenchTop arm models have been developed to cover a wide spectrum of needs:



**The ORIGINAL model** is a robust and reliable all-round arm for general applications where there is little risk of electrical discharges or attack by aggressive chemicals. The arm is shown fitted with a multi-purpose transparent hood.



**The ESD/EX model** is designed for use in electronic and explosive environments where there is a risk of electrostatic discharges. The arm is made of conductive materials, eliminating the risk of static electricity and sparks. The hood is made of anodized metal.



**The CHEM model** has profiles made of double anodized aluminium. The arm is ideal for fume extraction in aggressive environments where corrosion resistance must be assured. The arm shown here is fitted with a painted, corrosion-resistant metal hood.



*Metal hood*

*Multi-purpose hood*

## Universal mini hood and interface

Nederman BenchTop arms are supplied with a mini hood as standard – no extra extraction nozzle is required. The mini hood is also a universal interface for connecting to other hoods. A metal hood or transparent multi-purpose hood can be attached directly to the mini hood, irrespective of arm size.

The optional multi-purpose hood can be used both as a dome and a screen hood. It has excellent screening properties, is fully transparent and does not cause optical distortions. The hood can be easily angled to suit any extraction situation.



## Full range

**FX100**



**FX75**



**FX50**



*The new generation of Nederman BenchTop arms is available in 50, 75 and 100 mm versions with corresponding capacity ranges of FX50: 40-90m<sup>3</sup>/h, FX75: 70-175m<sup>3</sup>/h and FX100: 200-500m<sup>3</sup>/h.*

**FX32**



*For low-volume bench top extraction purposes there is a compact 32 mm version, comprising a one-piece, self-supporting, flexible arm.*



## From self-assembly kits to tailor-made solutions

Nederman BenchTop arms are available in self-assembly kits, which include a fan and filter, a fan speed controller, hoses, table bracket and connectors. The kit provides a quick and convenient solution for creating a fume-free workplace. Six different extraction kits are available.

For more information see the separate kit brochure or visit [www.nederman.com](http://www.nederman.com)

At Nederman we have both the products and the experience required to create customized extraction solutions, large or small. Our team of designers and engineers will help you construct a solution uniquely suited to your particular requirements. Our support services encompass every step – from consultation and design to installation and after sales service. Our design services are supported by full CAD facilities.



*Our self-assembly kits include everything you need.*



*Nederman has a complete range of fans, filters and controllers for every size of extraction system.*

# Product range

Extraction Arms	Connection direction*	Diameter (mm)	Length (mm)	ORIGINAL Part No.	ESD/EX Part No.	CHEM Part No.
		Up/Down	32	1000	70502834	70502934
<i>Connection up/down 32 mm</i>	Up/Down	50	700	70510144	70530144	-
	Down	50	1100	70510244	70530244	-
	Down	50	1500	70510444	70530444	-
	Up	50	1100	70510344	70530344	-
<i>Connection up 50/75/100 mm</i>	Up	50	1500	70510544	70530544	-
	Down	75	1100	70540144	70560144	70550144
	Down	75	1500	70540344	70560344	70550344
	Up	75	1100	70540244	70560244	70550244
<i>Connection down 50/75/100 mm</i>	Up	75	1500	70540444	70560444	70550444
	Up/Down	100	1200	70570144	70590144	70580144
	Down	100	1800	70570244	70590244	70580244
	Up	100	1800	70570344	70590344	70580344
	Up	100	2400	70570544	70590544	70580544

\* Note: Different spring mechanisms are fitted depending on connection direction

Accessories	Accessories	Diameter (mm)	Length (mm)	ORIGINAL Part No.	ESD/EX Part No.	CHEM Part No.
		Table bracket	32		70371761	70371761
<i>Table / Wall brackets 32</i>	Wall bracket	32		70371760	70371760	-
	Bracket complete	50 / 75 / 100	250	70501144	70501144	70501144
	Bracket	50 / 75 / 100		70501244	70501244	70501244
	Extension profile	50 / 75 / 100	1100	70501344	70501344	70501344
	Table bracket	50 / 75 / 100		70501444	70501444	70501444

Hoods	Hoods	Diameter (mm)	Size (mm)	ORIGINAL Part No.	ESD/EX Part No.	CHEM Part No.
		Flange hood	32	150x160	70371525	-
<i>Flangehood</i>	Dome hood 1/2	32	260x120	70371756	70371807	-
	Dome hood 1/1	32	Ø260	70371757	70371808	-
	Metal hood	50 / 75 / 100	Ø280	70500444	70500544	70500444
	Multi-purpose hood	50 / 75 / 100	380x460	70500144	70500244	70500344

Reducers	Reducers	Diameter (mm)		70500644	70500644	70500644
		Reducers	63		70500744	70500744
<i>Reducer 63 mm</i>	Reducers	75 - 80		70500844	70500844	70500844
	Reducers	100		70500944	70500944	70500944
	Reducers	125				
	Reducers					
	Reducers					

Hoses	Hoses	Diameter (mm)	Length (mm)	70501644	-	-
		Hose (white)	45	3000	70501544	-
Hose (grey)		75	3000	70501744	-	-
<i>Hoses white/grey 45/75/100/125 mm</i>	Hose (grey)	100	3000	70501844	-	-
	Hose (grey)	125	5000	-	70502044	-
	Hose ESD/EX (black)	45	3000	-	70501944	-
	Hose ESD/EX (black)	75	3000	-	70502144	-
<i>Hoses ESD/EX 45/75/100/125 mm</i>	Hose ESD/EX (black)	100	3000	-	70502244	-
	Hose ESD/EX (black)	125	3000	70400052	-	-
	Hose (black)	32	1500	70501044	-	70501044
	Cover ring					

***Nederman***

**[www.nederman.com](http://www.nederman.com)**

**Nederman is represented in:**

Australia, Austria, Bahrain, Belgium, Brazil, Bulgaria, Canada, China, the Czech Republic, Cyprus, Denmark, Egypt, Estonia, Finland, France, Germany, Greece, Hong Kong, Hungary, Iceland, India, Iran, Ireland, Italy, Japan, Korea, Latvia, Lithuania, Malaysia, the Netherlands, Norway, Philippines, Poland, Portugal, Romania, Russia, Saudi Arabia, Serbia & Montenegro, Singapore, Slovenia, South Africa, Spain, Sweden, Switzerland, Taiwan R.O.C., Thailand, Turkey, United Arab Emirates, United Kingdom, USA.